



**Together, Transforming a Blighted Area
to a Creative Cultural Community**



Shreveport Common

Shreveport Common, Inc.
Shreveport Regional Arts Council and City of Shreveport
and 50 Major Public/Private Partners



Shreveport Common

is a nationally awarded public/private
Creative Placemaking revitalization effort...





Shreveport Common

... transforming a historic, long-blighted 9-block area...





Shreveport Common

... to an UNcommon Creative Cultural Community for ALL

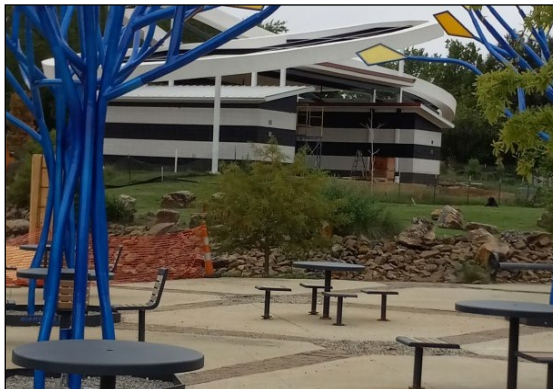



Shreveport Common

Built on the Community's Tenets for Revitalization
Authentic, Creative, Sustainable, For Community

with no displacement of the current neighbors

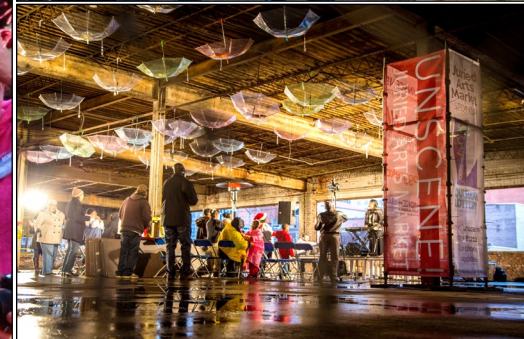

SHREVEPORT COMMON connects Shreveport's
Downtown Business District
and Ledbetter Heights a HUD Choice neighborhood



Building a Creative and Equitable Cultural Economy

**SPIRITED UNCOMMON
ARTS & CULTURE**



**A UNIQUE BUILT-
ENVIRONMENT**



**DYNAMIC
ECONOMIC
DEVELOPMENT**



**ENHANCED
SOCIAL/COMMUNITY
DEVELOPMENT**

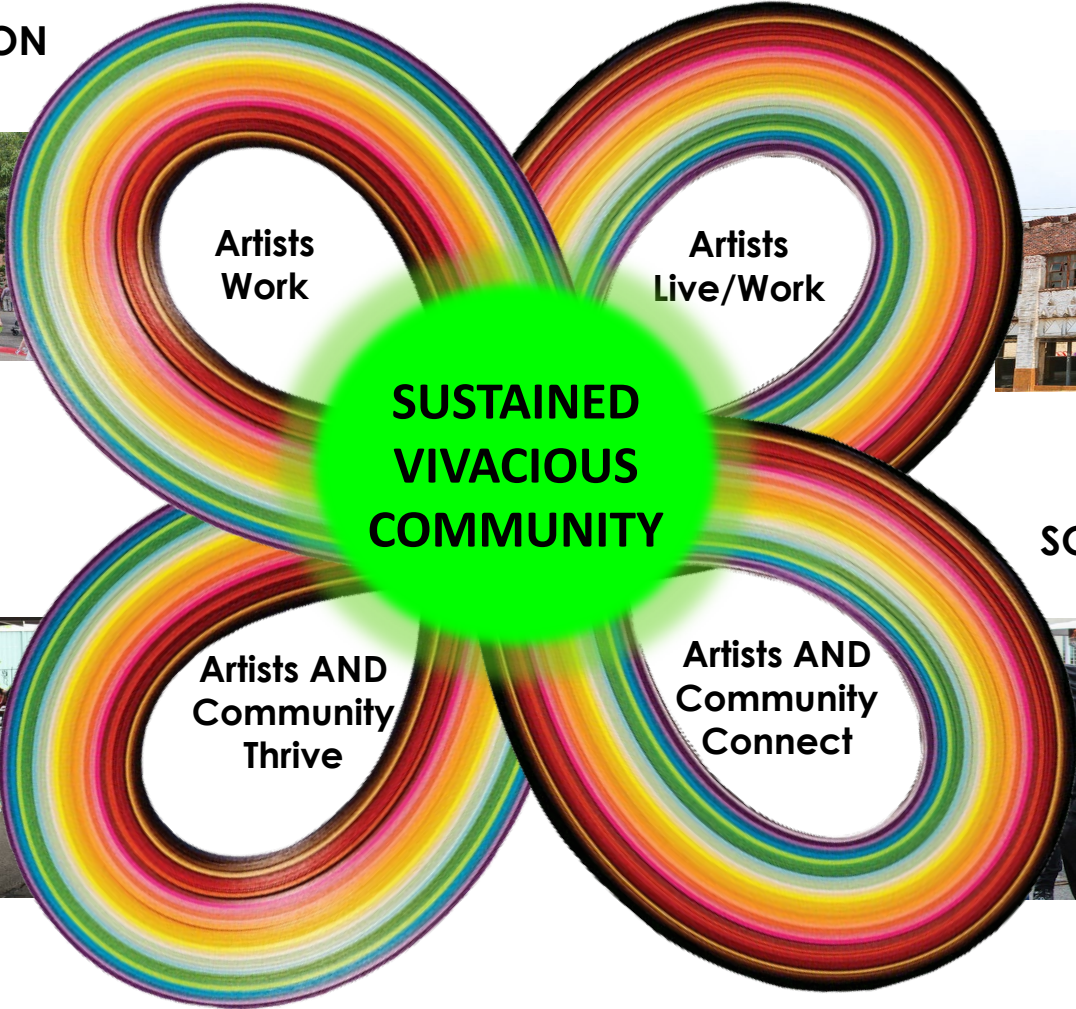

**Artists
Work**

**Artists
Live/Work**

**SUSTAINED
VIVACIOUS
COMMUNITY**

**Artists AND
Community
Thrive**

**Artists AND
Community
Connect**

A community comes **TOGETHER** to Envision, then Revitalize the long-blighted area to an **UNCOMMON** Urban Neighborhood



Over 50 Partners, Each Doing Their Part to Lift the Area

SRAC

**PUBLIC ART
PROGRAMMING
ARTIST OPPORTUNITIES**

*Creating a Vibrant
UNCOMMON Community,
Access, Artist Economy*

City of Shreveport

**PUBLIC VENUES
INFRASTRUCTURE**

*Preserving the Urban
Core for Economic and
Community
Development*

Shreveport Common, Inc.

**Public/Private
REDEVELOPMENT**

*Actively Motivating
Revitalization of Spaces
& Places*

Residents & Business Owners

COMMUNITY

*Growing Neighborhood
and Commerce*

Private Donors

**STAKEHOLDERS
PRIVATE SUPPORT
For Economic
Community and
Cultural Development**

Caddo Parish Commission, State of LA, DDA, Federal Nonprofits

**PUBLIC SUPPORT
For Economic
Community and
Cultural Development**

Property Owners

**PRIVATE
DEVELOPMENT**

*Restoring and
Repurposing Historic
Properties*



A community comes TOGETHER to Envision, then Revitalize the long-blighted area to an UNCOMMON Urban Neighborhood

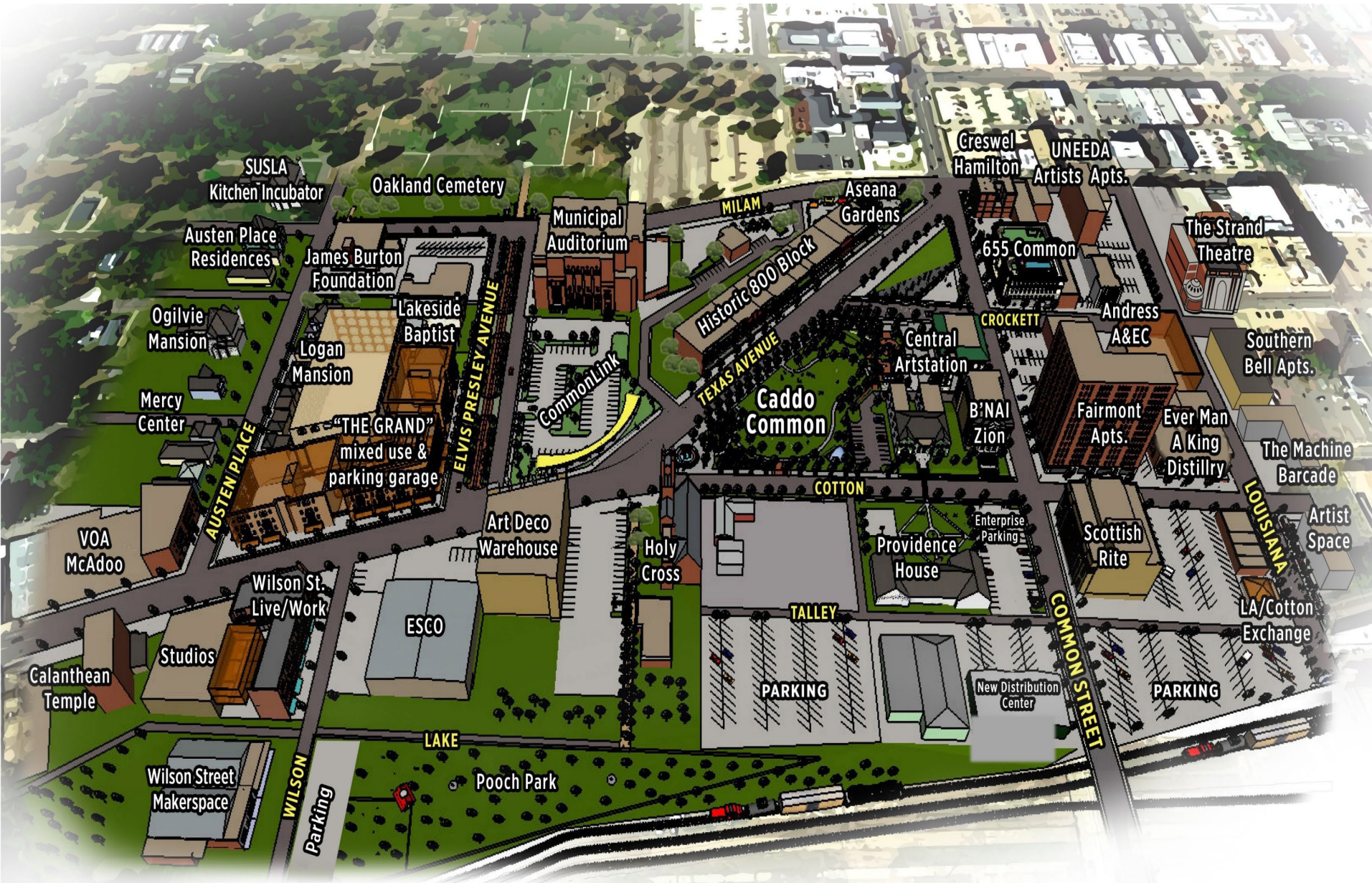

50+ Public/Private Partners have invested \$56 million Preserving/redeveloping endangered properties Growing unique live/work, makerspaces & FUN for ALL



When We Come Together, We Can...



... Make BIG Change...



Caddo Common Park Open!

Performance Pavilion, Food Truck Court with Artist Trees and Table Sets
Water Feature and FUN & GAMES with
UNCOMMON Interactive Art Programming, Events & Markets

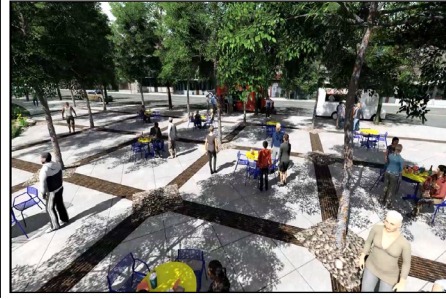

Animated Timeline from Plan to Implementation

2012 – 2022: Revitalizing an important urban area

50+ partners - \$58 million in long term improvements

- 33 Completed Redevelopment/Preservation Projects
- 6 Public & Private Projects Under Construction

- 18 Active Projects in Pre-Development - \$ spent
- 4 For Sale/Under Contract
- 3 RFP for New Dev. coming soon



What's Next – Under Construction and Starting Soon



UNEEDA Artist Apts.
Exp. early Fall 2023
OPEN!



BNAI Zion Bldg. @ Cotton St. to become
Sanctuary Glass Arts School. Exp. capital
campaign to early Summer 2023



EPIC Artist Makerspace
Exp. Fall 2024



Programming in Caddo Common
Park returns Spring 2023



Former Creswell Hotel has new
owners. Exp. retail & short
term/long term rentals Fall 2024

Every Man A King starts w/ the Revenir
Restaurant completion Exp. Spring 2024



The Revitalization of Shreveport Common is a Creative Placemaking Community Effort

More than 25 Private Property Owners have preserved/made investments in their properties and eagerly participate in creating a vibrant, cultural community AND these major partners & donors:

- City of Shreveport (SPAR, Office of Community Development, Engineering, Economic Development) and Shreveport City Council
- Shreveport Regional Arts Council
- Shreveport Common, Inc.
- Educational Foundation of America
- Shreveport H.U.D. Choice Neighborhoods
- Caddo Parish Commission
- The Kallenberg Family
- National Endowment for the Arts
- Artplace America
- Louisiana Division of the Arts
- J P Morgan Chase Foundation
- Ralph and Laura Whitley
- Jeff and Tamie Lowe
- The Anderson Family
- The Beaird Family Foundation
- Community Foundation NLA – Kinsey Family Designated Funds
- Val Clary (property donation)
- Jackson B. Davis Family (property donation)
- Bob Cochran (property donation)
- Anonymous Family (property donation)
- Shreveport Landmark (property donation)
- SWEPCO
- State of Louisiana Dept. of Environmental Quality
- The Grayson Foundation
- Caddo Parish Parks and Recreation
- SporTran Public Transportation
- Fred Phillips Family
- Rocko Landesman
- Coca Cola Bottling
- Chamber of Commerce Young Leadership
- Community Foundation Give for Good Donors
- AARP
- Downtown Development Authority
- Rob Cochran
- Storer Services
- Jones Environmental
- Keith D Peterson Insurance
- Trenton Siskron KW Commercial
- The Chambers Family Trust
- The Red River Rotary
- RE:FORM Shreveport
- NWLA Roster Artists

SHREVEPORT COMMON AN UNCOMMON CREATIVE CULTURAL COMMUNITY

VOTED #1 Community Development Project in the Nation
National Development Council Academy, Washington, DC 2015 -16



CALL FOR A TOUR 318.673.6537

CHECK US OUT ON facebook

VISIT OUR WEBSITE ShreveportCommon.com

